

THE BROWNE:

A Colorful Pollinator-Friendly Corner

SIZE: 20 x 20 ft. | 1 square = approximately 2 sq. ft. | 314 sq. ft

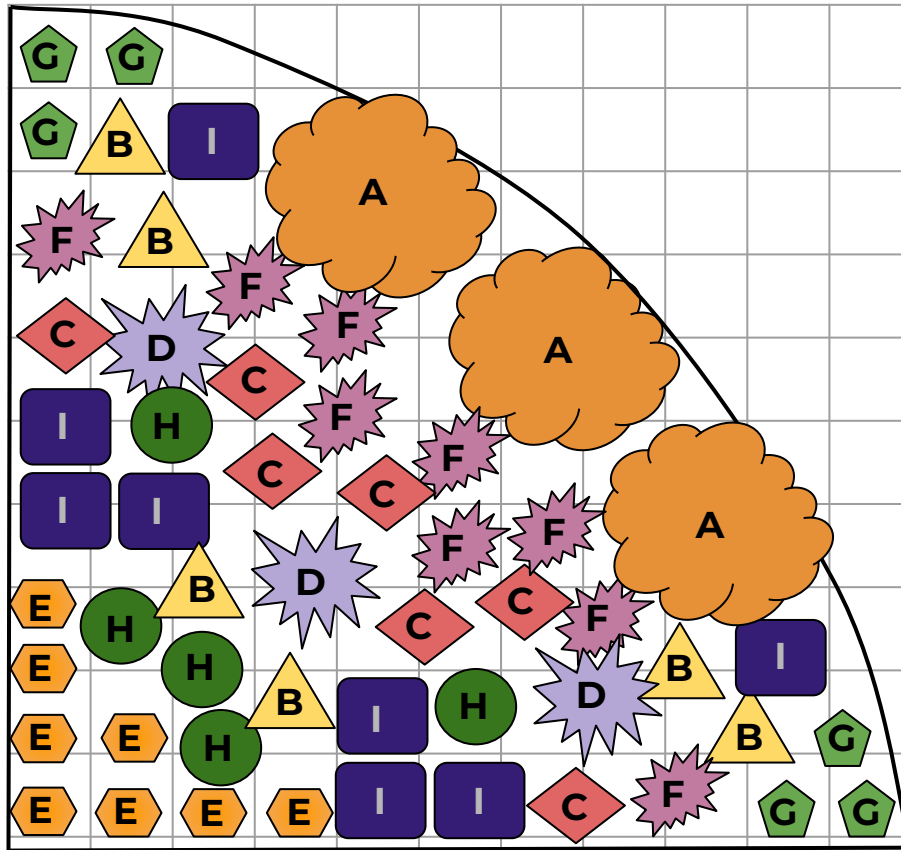

ABOUT THIS DESIGN:

This colorful drought-tolerant landscape is meant for spaces with 6+ hours of direct sun per day. Abundant pollinator-friendly perennials provide year-round color, texture, and interest in a corner of your landscape. Prepare for beautiful and productive interest in a visible corner of your space, perhaps where sidewalks and/or your driveway meets and your guests arrive!

SUGGESTED PLANTS (at avg. maturity):

- A:** Gro-Low Fragrant Sumac (8x2 ft) = 3
- B:** Rudbeckia "Amer. Gold Rush" (2x2 ft) = 6
- C:** Yarrow "Paprika" (3x2 ft) = 7
- D:** Russian Sage "Blue Spire" (4x4 ft) = 3
- E:** Creeping H'bird Trumpet Vine (6x16 in) = 8
- F:** Purple Echinacea (3x2 in) = 9
- G:** Sedum "Angelina" (6x18 in) = 6
- H:** Fountain Grass "Hameln" (3x2 ft) = 5
- I:** Salvia "Caradonna" (2x2 ft) = 8